





LED WINDSHIELD TRIM FOR FLTR – CHROME

1338

THANK YOU FOR CHOOSING KÜRYAKYN!

PROTECT YOURSELF AND OTHERS FROM POSSIBLE INJURY AND/OR PROPERTY DAMAGE OR LOSS. PAY CLOSE ATTENTION TO ALL INSTRUCTIONS, WARNINGS, CAUTIONS, AND NOTICES REGARDING THE INSTALLATION, USE, AND CARE OF THIS PRODUCT.

 WARNING	THIS INDICATION ALERTS YOU TO THE FACT THAT IGNORING THE CONTENTS DESCRIBED HEREIN CAN RESULT IN POTENTIAL DEATH OR SERIOUS INJURY.
 CAUTION	This indication alerts you to the fact that ignoring the contents described herein can result in minor or moderate potential injury.
 NOTICE	This indication alerts you to the fact that ignoring the contents described herein may negatively affect product performance and functionality or damage the product itself or the product to which it is being attached.

MAKE SURE THE FOLLOWING PARTS HAVE BEEN INCLUDED IN THE KIT:

- 1 Right Windshield Trim — Chrome
- 1 Middle Windshield Trim — Chrome
- 1 Left Windshield Trim — Chrome
- 1 Windshield Hardware Kit containing:
 - 4 Windshield trim standoffs
 - 4 #6 lock washers
 - 4 #6 flat washers
 - 4 #6-32 X 3/8" button socket head screws
- 1 Turn Signal Hardware Kit containing:
 - 1 6-pin adapter
 - 2 Y-connectors
 - 1 Dielectric grease pack
- 1 Installation Instructions

TOOLS SUGGESTED

Phillips-head screwdriver, set of hex wrenches, socket set and ratchet, combination wrenches, Torx drivers, in/lbs and ft/lbs torque wrench

NOTICE

This copy of installation instructions contains important information. Ensure that the end user receives this copy and is aware of its importance for future reference.

- STEP 1** Read and understand all steps in the instructions before starting the installation. Park the motorcycle on a hard, level surface and turn off the ignition.

NOTICE

A factory service manual may be helpful in performing this installation. Do not attempt this installation and consult a trained technician if you are not confident in your ability to complete all of the steps in these instructions.

Avoid damage to the motorcycle. Protect painted surfaces with a soft cloth, blanket, or service cover.

CUSTOMER SERVICE

877.370.3604 (toll free)

INSTALLATION QUESTIONS

techsupport@kuryakyn.com
or call 715.247.2983

LIMITED WARRANTY

Kuryakyn warrants that any Kuryakyn products sold hereunder, shall be free of defects in materials and workmanship for a period of one (1) year from the date of purchase by the consumer excepting the following provisions:

- Kuryakyn shall have no obligation in the event the customer is unable to provide a receipt showing the date the customer purchased the product(s).
 - The product must be properly installed, maintained and operated under normal conditions.
 - Kuryakyn makes no warranty, expressed or implied, with respect to any gold plated products.
 - Kuryakyn shall not be liable for any consequential and incidental damages, including labor and paint, resulting from failure of a Kuryakyn product, failure to deliver, delay in delivery, delivery in nonconforming condition, or for any breach of contract or duty between Kuryakyn and a customer.
- Kuryakyn products are often intended for use in specific applications. Kuryakyn makes no warranty if a Kuryakyn product is used in applications other than intended.
- Kuryakyn electrical products are warranted for one (1) year from the date of purchase by the consumer. L.E.D.'S contained in components of Kuryakyn products will be warranted for defects in materials and workmanship for 3 years from the date of purchase where as all other components shall be warranted for one(1) year. This includes, but is not limited to; control modules, wiring, chrome & other components.

• Kuryakyn makes no warranty of any kind in regard to other manufacturer's products distributed by Kuryakyn. Kuryakyn will pass on all warranties made by the manufacturer and where possible, will expedite the claim on behalf of the customer, but ultimately, responsibility for disposition of the warranty claim lies with the manufacturer.

ABOUT OUR CATALOG

For purchasing Kuryakyn® products, you can receive a complete catalog free of charge.

Send the Proof-of-Purchase below with your address to: Kuryakyn
454 County Road V V
Somerset, WI 54025-9031
Please indicate either Accessories Catalog for Harley-Davidson® or GL & Metric Cruisers.

Be sure to ask your local dealer about other Kuryakyn® products, the motorcycle parts and accessories designed for riders by riders.

©2005 Kuryakyn USA® All Rights reserved.



REMOVE THE OUTER FAIRING:

Kuryakyn

- STEP 2** Remove the screws and washers securing the windshield to the fairing; set the screws and windshield aside for now. One screw and all five washers will be reused.
- STEP 3** Remove the rubber well-nuts and rubber washers from the fairing; set them aside, they will be re-used.
- STEP 4** Remove the acorn nuts and flat washers securing the turn signal assemblies to the fairing; set the nuts and washers aside they will be re-used later. Pull the turn signal assemblies away from the fairing. Older models require removal of a stud plate from the inner fairing support.

NOTE: **Secure the turn signal assemblies to the engine guard with zip ties or masking tape to keep them from falling once the fairing is removed.**

- STEP 5** Refer to **PIC 1**. Remove the Torx screws (**1**) and (**2**) from both sides; set them aside they will be re-used later. Note that the lower screws (**1**) are long and the middle screws (**2**) are short.

NOTE: **Assistance is recommended when removing the outer fairing to minimize the possibility of damage.**

- STEP 6** Refer to **PIC 1**. Remove the upper Torx screws (**3**) from both sides; set them aside for now.
- STEP 7** Lift up on the front of the fairing to disengage it from the bike.
- STEP 8** Squeeze the two tabs on one of the headlight connectors and CAREFULLY disconnect it from the bulb. Repeat for the other bulb.
- STEP 9** Remove the outer fairing from the bike; set it on a soft blanket on a sturdy surface.

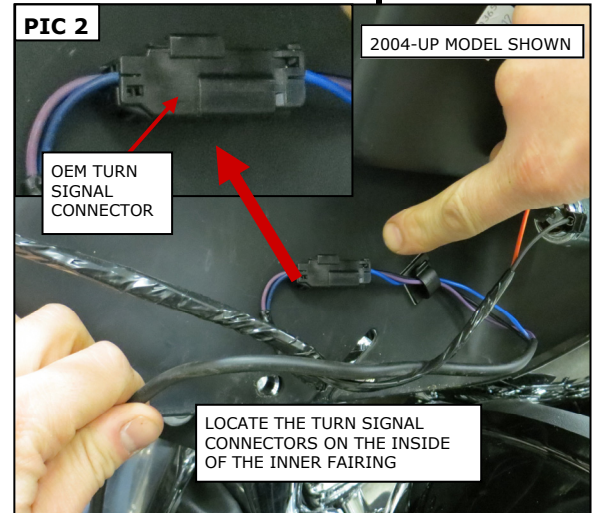
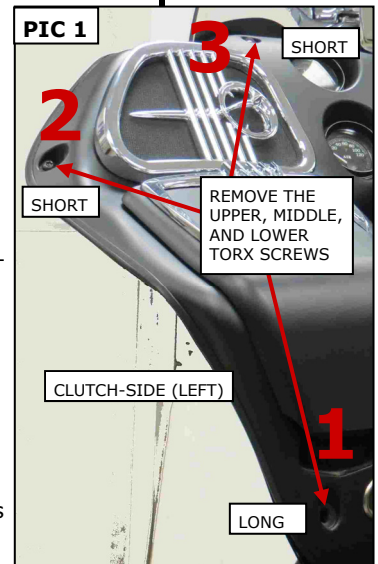

INSTALL THE TURN SIGNAL WIRING ADAPTERS:

- STEP 10** Refer to **PIC 2**. Disconnect the OEM turn signal connectors.

NOTE: **'98-'03 MODELS: have a 6-pin connector located on the clutch-side (left) of the fairing. The black 6-pin connector is usually taped to a wiring harness. Disconnect the 6-pin connector.**

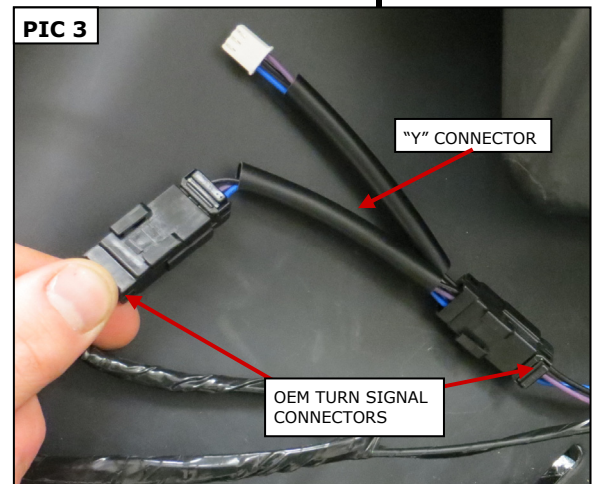

NOTICE

Kuryakyn recommends the use of the included dielectric grease on ALL electrical connections.

- STEP 11** Locate the included "Y" connectors. Apply some of the included dielectric grease to the open ends of **ALL** the connectors.
- STEP 12** Refer to **PIC 3**. Connect the "Y" connectors to the turn signal connectors.

NOTE: **'98-'03 MODELS: locate the included 6-pin adapter; apply dielectric grease to the open ends, then connect the it inline with the OEM turn signal wiring.**

-cont.-

PAGE
2

INSTALL THE LED WINDSHIELD TRIM:

NOTICE

MEASURE TWICE – DRILL ONCE. Double check all reference marks made on the fairing **BEFORE** drilling. Kuryakyn will not be responsible for incidental or consequential damages resulting from this installation.

STEP 13 Refer to **PIC 4**. Carefully mark and drill a 7/16" hole 1 1/2" from the holes towards the center and 3/4" up from the ledge as shown in **PIC 4**.

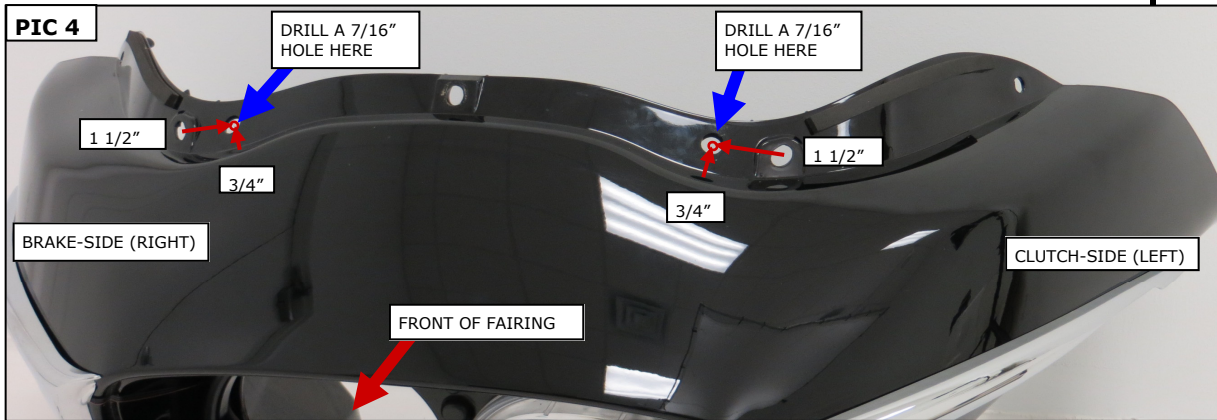

STEP 14 Refer to **PIC 5**. Determine the left Trim from the right.

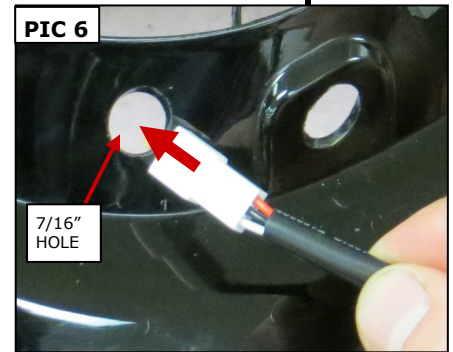

STEP 15 Refer to **PIC 6**. Insert the left side Trim wire through the left side hole drilled in the **STEP 13**. Repeat for the other side.

STEP 16 Refer to **PIC 7**. Insert the well nuts with rubber washers in their holes.

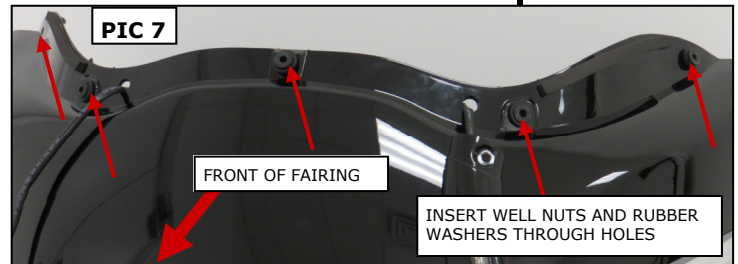

STEP 17 Remove four (4) of the plastic washers from the OEM windshield screws and place them on the included windshield trim stand offs; set them within arms reach of the work area. Leave one OEM screw with plastic washer for use in the next step

STEP 18 Hold the windshield in place; insert the OEM screw with plastic washer through the center windshield hole and into the well nut, then snug the screw.

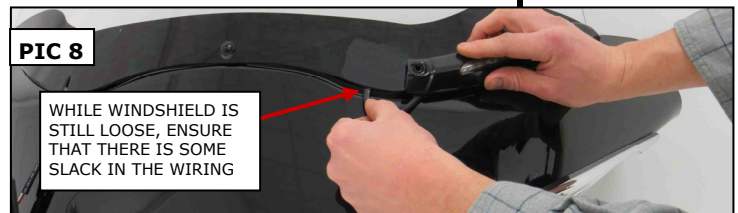

NOTE: Refer to **PIC 8**. Ensure that there is some slack in the wiring before fully securing the windshield to the fairing.

STEP 19 Refer to **PIC 9**. Insert the windshield trim stand offs through the remaining holes in the windshield and well nuts. Alternately tighten the OEM screw and stand offs.



-cont.-

STEP 20 Place an included #6 lock washer and flat washer on each of the included #6 screws; set them within arms reach of the work area for now.

STEP 21 Refer to **PIC 10**. Secure the two side trim pieces to the rear standoffs with the #6 screws and washers; leave both the screws finger tight for now.

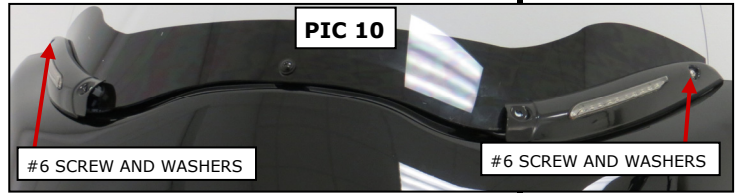

NOTE: Refer to **PIC 11**. Tuck the extra wiring under the windshield before installing the center Trim piece.



NOTICE

Secure all wiring away from any moving parts, pinch points or extreme heat. Kuryakyn WILL NOT warranty any electrical component that fails due to pinched, crimped, broken, abraded, melted or frayed wires.

STEP 22 Align the center trim piece over the side trim pieces and front standoffs; secure it with the two remaining #6 screws and washers. Alternately tighten all four screws.

REINSTALL THE OUTER FAIRING:

STEP 23 Reconnect the headlights.

WARNING

VISIBILITY IS A **MAJOR CONCERN FOR MOTORCYCLISTS**. A LIGHT MALFUNCTION COULD RESULT IN DEATH OR SERIOUS INJURY. ENSURE PROPER LIGHT OPERATION **BEFORE RIDING THE MOTORCYCLE**.

STEP 24 Connect the Trim wiring to the "Y" connectors; test for the proper function of **ALL** lights.

NOTE: '98-'03 MODELS: The longer wiring lead will connect to the brake-side (right) Trim connector. The short lead connects to the clutch-side (left) Trim connector.

STEP 25 Reinstall the fairing. Care should be taken not to over tighten and strip the Torx screws. **Torque the fasteners to the factory service manual requirements.**

STEP 26 Reinstall the turn signal assemblies. **Torque the fasteners to the factory service manual requirements.**

NOTICE

It is the end user's responsibility to ensure that all of the fasteners (including pre-assembled) are tightened before operation of the motorcycle. Kuryakyn will not provide warranty coverage on products or components lost due to improper installation or lack of maintenance. Periodic inspection and maintenance are required on all fasteners.